

Library Information

■ Entrance

Your student ID, staff ID or library user card is needed to enter the library.
If you do not have such card, please apply for it at the counter.

■ Use of materials

Borrowing

Please use your student ID, staff ID or library user card to borrow books at the counter or from the self-checkout machine.

Returning

Please return the borrowed materials to the counter.
When the library is closed, put them into the book post in front of the entrance.

Classification	Number of books	Loan period	
Undergraduate/ Postgraduate students Faculty/staff	10 books	Two weeks	• You can repeat the loan period up to twice during the loan period unless another person's reservation has been made. People inside the university can extend the loan period on the website. • If you failed to return books by the due date, your allowed extension period shall be shortened by the delayed days.
Graduates Open University students	5 books	Two weeks	
People outside the university	3 books	Two weeks	

Please use the OPAC to search for materials at the address below. You can search for them from outside the university.
<http://opac.lb.nagasaki-u.ac.jp/opac/>

Reservation and request for collection (people inside the university)

If the book you wish to borrow is on loan or placed at another campus of the university, you can make a reservation or a request for collection at the counter on the OPAC.

■ Request (Student-requested books)

Students can request books for the library (only undergraduates and postgraduates). Requests are accepted at the library counter or through the library website.

Medical common library (on the 10th floor of Nagasaki University Hospital outpatient wing)

There are clinical academic journals in the fields of medicine and dentistry, and PCs for users. The library provides services for the application and pickup of photocopied documents as well as a reference service (weekdays from 14:00 to 15:00). With a hospital entry card, you can use the room 24 hours a day.

■ Reminders

- Please keep quiet in the library and refrain from any act imposing trouble on other users.
- Set your cellphone to manner mode and only talk in the designated area.
- If you need drinking water, you are requested to bring in only a plastic bottle or canteen.
- Meals (light meals) are available only at the refreshment corner on the first floor.
- Drinking and smoking are prohibited in the library.
- Please keep your valuables with you.
- Please treat materials with great care.
- In case you have damaged, stained, or lost materials, you need to compensate for that in principle. Please report to the staff promptly.
- Taking out materials without permission is prohibited.

■ Sakamoto campus map

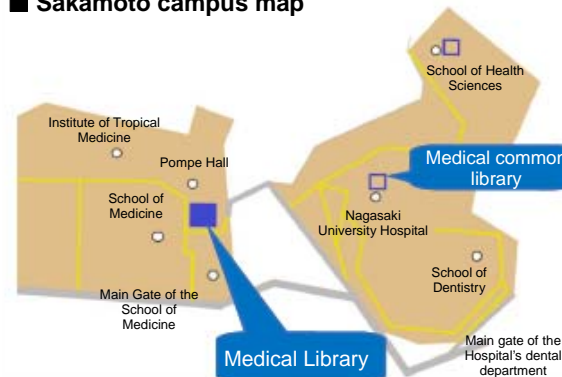

Opening hours

Days of week	Ordinary days
Monday through Friday	8:30~22:00
Saturdays, Sundays and holidays	10:00~20:00

Closed days: Summer vacation shutdown, year-end and new year's holidays, March 31
*Temporary closure will be notified on the bulletin board and the library website.



Medical Library of Nagasaki University Library

1-12-4, Sakamoto, Nagasaki-shi, 852-8523
Tel: 095-819-7014
Mail: medlib@ml.nagasaki-u.ac.jp
URL: <http://www.lb.nagasaki-u.ac.jp/>



Nagasaki University Library

Medical Library User Guide

Floor Map

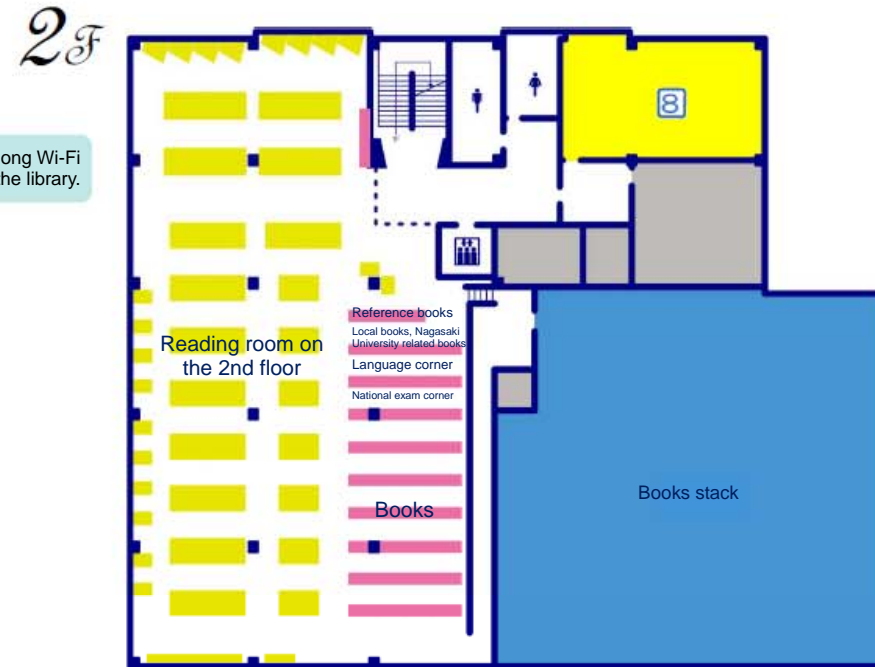
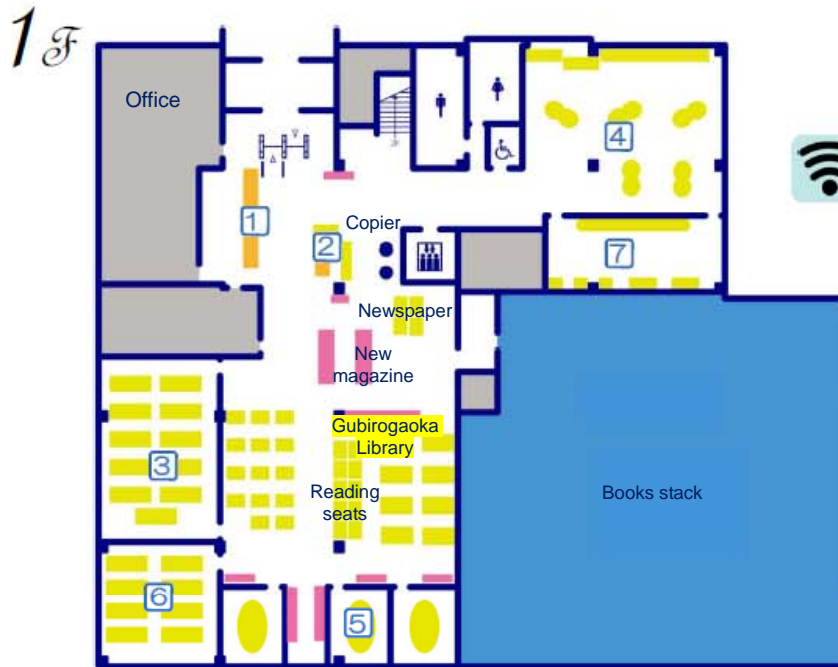

You can use long Wi-Fi anywhere in the library.

- 1 Counter**
Make applications at the counter for items such as the borrowing and return of books, photocopying of documents and library facility use.
- 2 ICT Support Counter**
Ask about any ICT-related issues including how to use the PC and tablet.
- 3 PC Room Learning Commons**
- 4** The PCs which are connected to the University LAN are available. You can print documents using the copiers (printers paid for by the coop) in the library. Printing and photocopying are charged. You may photocopy the library materials within copyright law. [10 yen per monochrome page/40 yen per color page]
- 5 Group Study Room Seminar Room**
- 6** Make an application to use the rooms at the counter.
- 7 Refresh Corner**
Use this corner for drinking and eating, and talking on your cellphone/PHS.

- 8 Exhibition Room**
Historical materials on Japanese modern Western medicine including "Paper Anatomical Models" and "Koigekasoden" (a book written by a French surgeon) are exhibited. Make an application for a visit tour at the counter.

Arrangement of materials

First floor	New magazines, new books
Second floor	Reference books General books National exam corner Language corner Audiovisual corner (DVD)
First layer of the library	Back issues of Japanese magazines
Second layer of the library	Back issues of foreign magazines, books
Third layer of the library	Back issues of foreign magazines

The books in each corner are arranged in order of their call marks (back label).

Reference and reference research

Reference service
The reference service is provided to help you find the necessary information for learning, study and research. You may make an application at the counter or through the library website. Requests for photocopies/loans from other libraries (*only Nagasaki University officials and graduates)

You may borrow books and photocopies of these not owned by Nagasaki University Library from outside libraries.

Part of the medical database available at Nagasaki University

PubMed (exclusive use by Nagasaki University)	Japan Medical Abstracts Society Web
SCOPUS	Latest Nursing Index Web
Today's Medical Treatment Web	CiNii
CochraneLibrary	Medical online
UpToDate	DynaMed

"Library guidance" and briefing sessions for using the electronic journal database are provided for Nagasaki University officials.